

# Product Information

Control No. : ARP-4870400-L 1

Issued on April 1, 2025

## 1. Type No.

HMD8704F

RoHS Compliant Part

## 2. Dimension (Unit : mm)

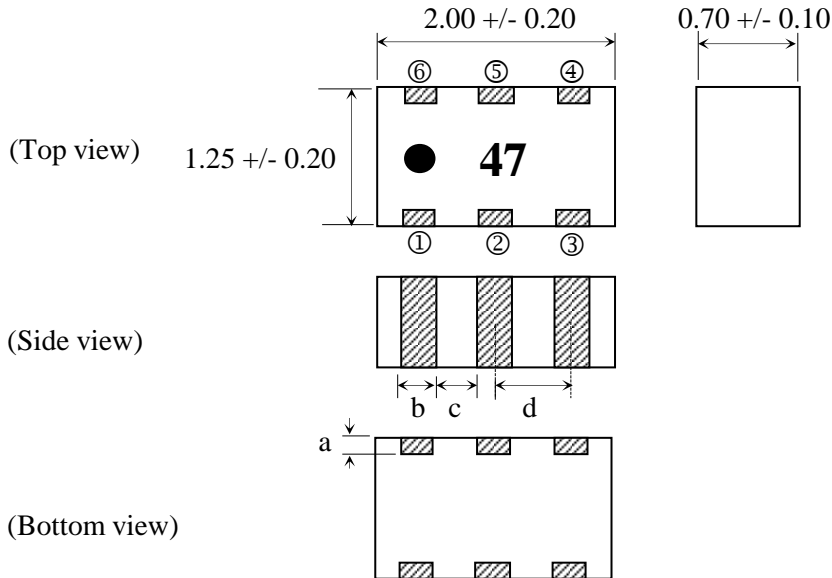

Terminal	
①	GND
②	Input
③	GND
④	Output1
⑤	GND
⑥	Output2

Terminal Dimensions	
a	0.19typ.
b	0.30 +/- 0.15
c	0.35 +/- 0.15
d	0.65 +/- 0.15

## 3. Electrical characteristics

Parameter		Band1	Band2	Band3	Band4	Band5	Band6	Unit
Frequency Range	Specification	2300-2500	2500-3600	3600-3800	3800-4200	4200-4600	4600-5000	MHz
Nominal impedance	Specification	50	50	50	50	50	50	ohm
Insertion Loss at 25 deg C.	Specification	max 0.60	max 0.50	max 0.50	max 0.50	max 0.55	max 0.80	dB
	Typical	0.36	0.35	0.09	0.18	0.31	0.53	
Input Return Loss	Specification	min 8.0	min 10.0	min 10.0	min 10.0	min 10.0	min 9.0	dB
	Typical	10.8	11.2	20.2	20.0	14.1	11.2	
Isolation	Specification	min 12.5	min 15.0	min 12.5	min 10.0	min 10.0	min 10.0	dB
	Typical	15.2	17.4	17.7	15.0	13.0	11.4	
Amplitude balance	Specification	max 0.20	max 0.20	max 0.20	max 0.20	max 0.20	max 0.20	dB
	Typical	0.03	0.05	0.05	0.05	0.05	0.04	
Phase balance	Specification	max 2.0	max 2.0	max 2.0	max 2.0	max 2.0	max 2.0	deg
	Typical	0.16	0.09	0.11	0.32	0.47	0.76	

## 4. Note

- |                                 |  |
|---------------------------------|--|
| 4.1 Operating Temperature Range | : -40 to +105 deg C.                       |
| 4.2 Storage Temperature Range   | : -20 to +35 deg C. (In a Taping Package)  |
| 4.3 Max Input Power             | : 5W Avg/CW(Band1~5)<br>: 3W Avg/CW(Band6) |
| 4.4 Standard Reel Quantity      | : 2,000 pcs (per reel, per bag)            |

Approved by	Confirmed by	Raised by
Y. Imai	S.Suzuki	H.Isono

SOSHIN ELECTRIC CO., LTD

# Product Information

Control No. : ARP-4870400-L2

Issued on April 1, 2025

## 5.Representative characteristics

Measured data

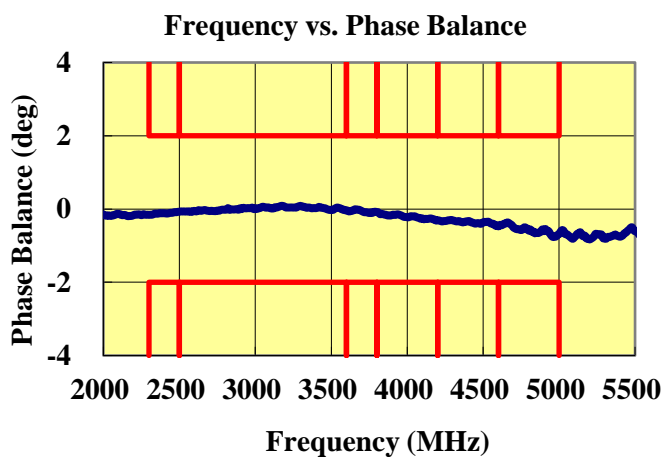
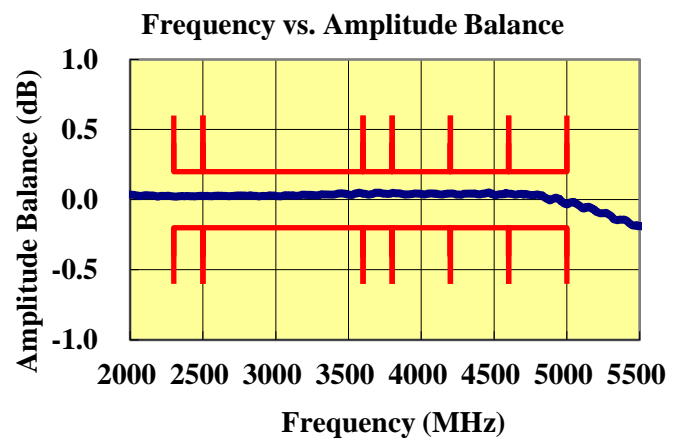
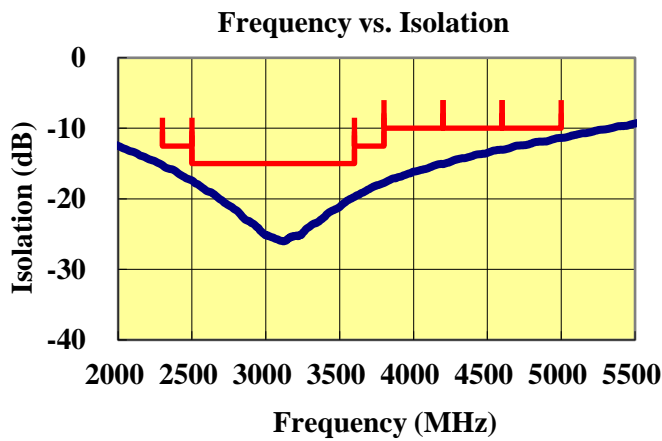
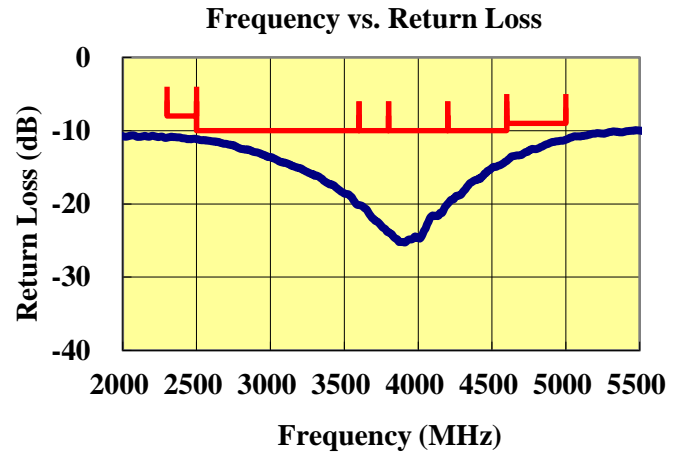
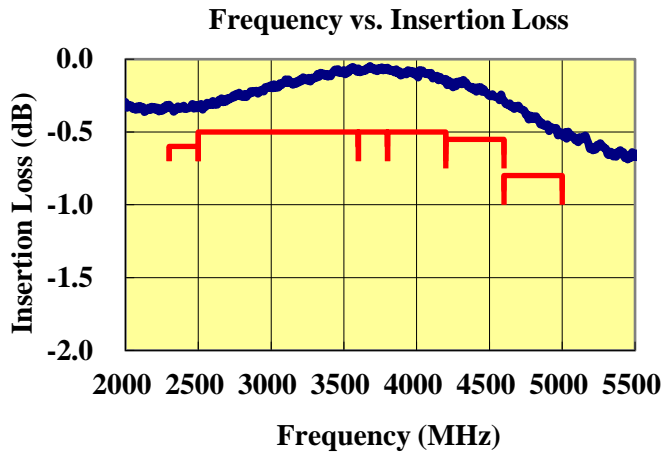

## 6.Measurement Circuit

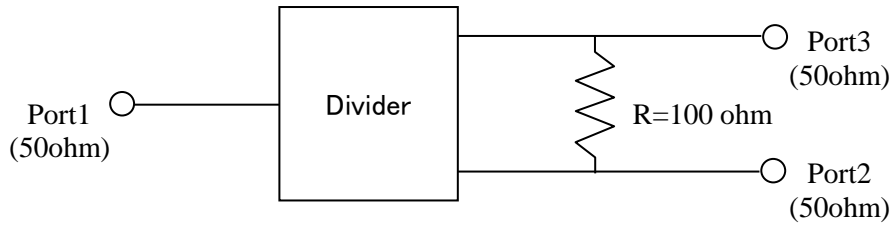

## 7.Recommended Land Pattern (Unit:mm)

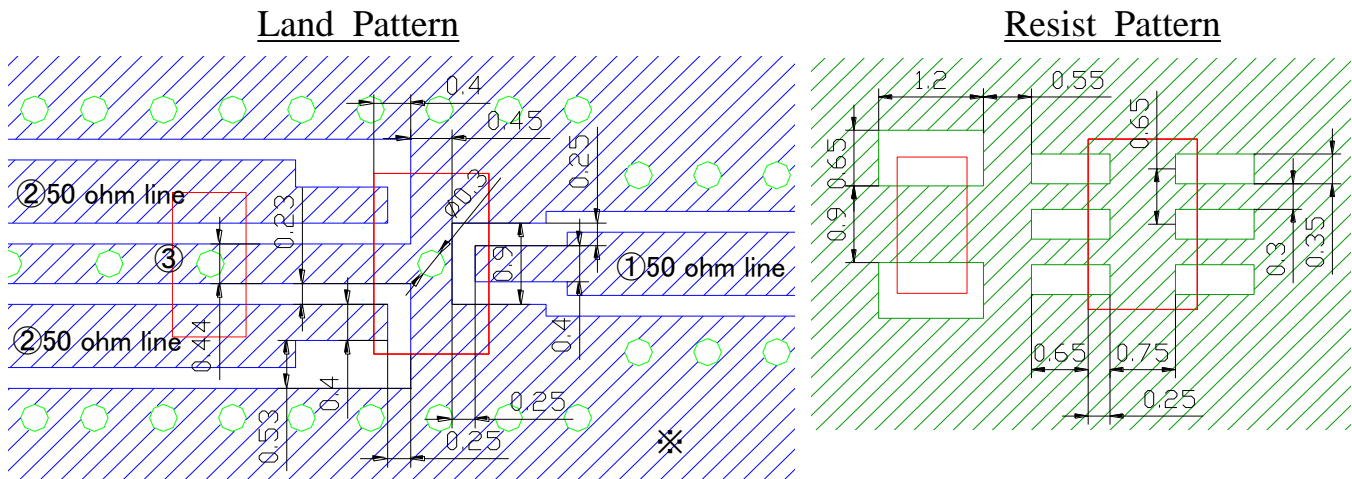

- ① Input
- ② Output1,2
- ③ 1608Size R=100ohm
- ※ GND

## 8.Power Derating Curve

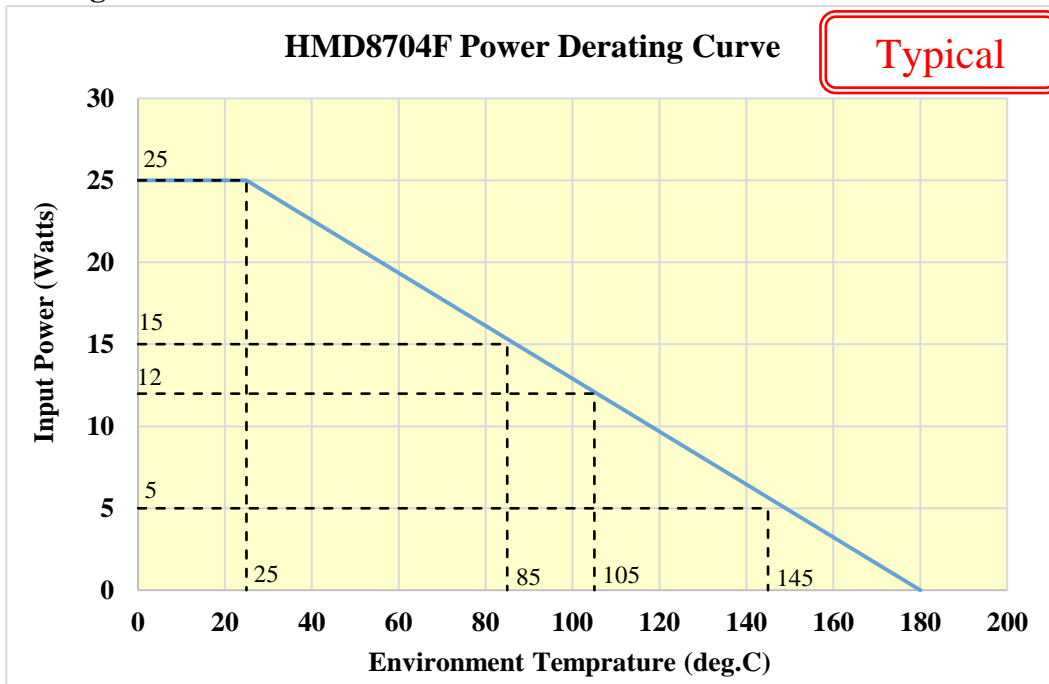

9. Packing method

9.1 Taping conditions

Taping conditions are shown below. Refer to IEC60286-3

- (1) Tape must be wound clockwise with the feeding hole coming to the right hand side.
- (2) Top cover tape must not cover feeding holes of carrier tape and/or show out of carrier tape.
- (3) A blank section carrying no chips of a length of 160mm min. on ending section and 100mm min. on leading section must be provided.
- (4) A leading section of 400mm min. must be provided on top cover tape.

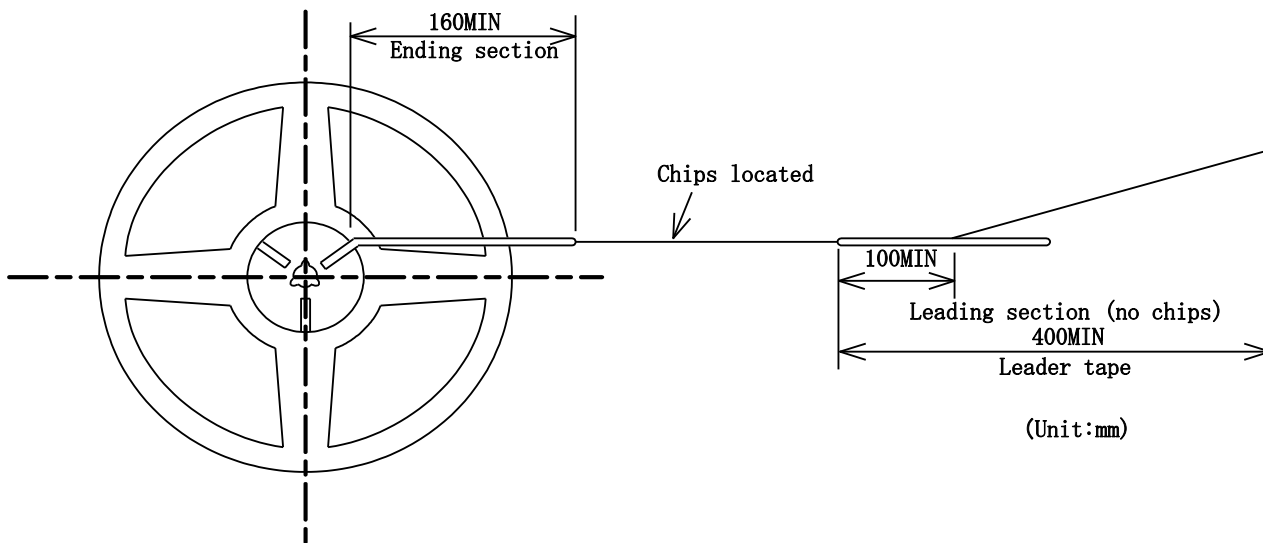

- (5) To end tape winding, the leading section of top cover tape must be stuck on a side of a reel with adhesive tape.
- (6) Removing force of top cover tape in the unwinding with an angle of 170 degrees between the removed side of a reel and carrier tape must be 0.1 to 1.0N.
- (7) When the embossed tape is turned upside down with the sealing tape peeled off, the filter body inside of the tape must fall off and the mounter must not cause a take-up mistake.
- (8) A sticker carrying Soshin product №, quantity, lot №, inspection date is to be placed on the specified side of reels. And Lot No. means our production control number. The shipment records are available if requested.

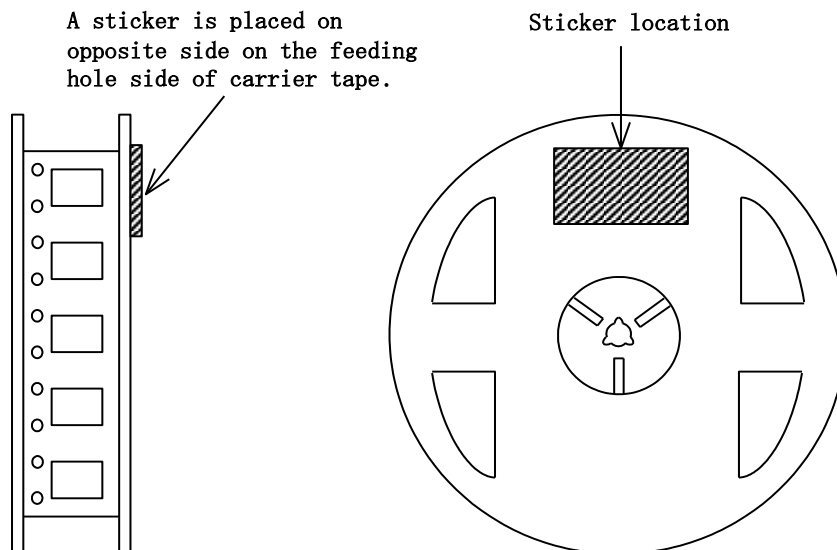

(8) Product orientation must be consistent. Products must not be positioned out of the mounting location.

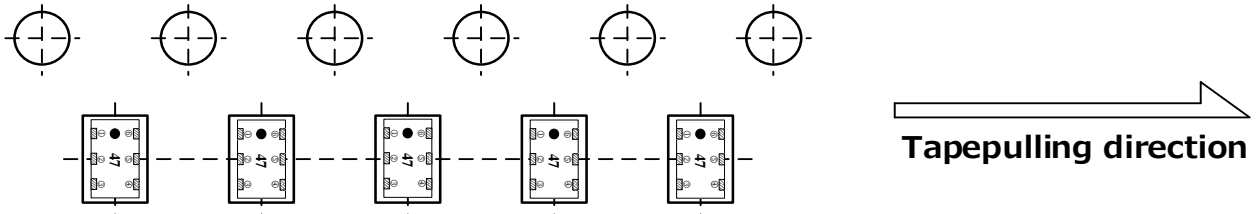

(9) A taping reel must be sealed in a plastic bag, individually.

(10) Tape-packaged quantity

The quantity is 2,000 pcs per single tape-package as a rule.

9.2 Dimensions of the carrier tape (Unit : mm)

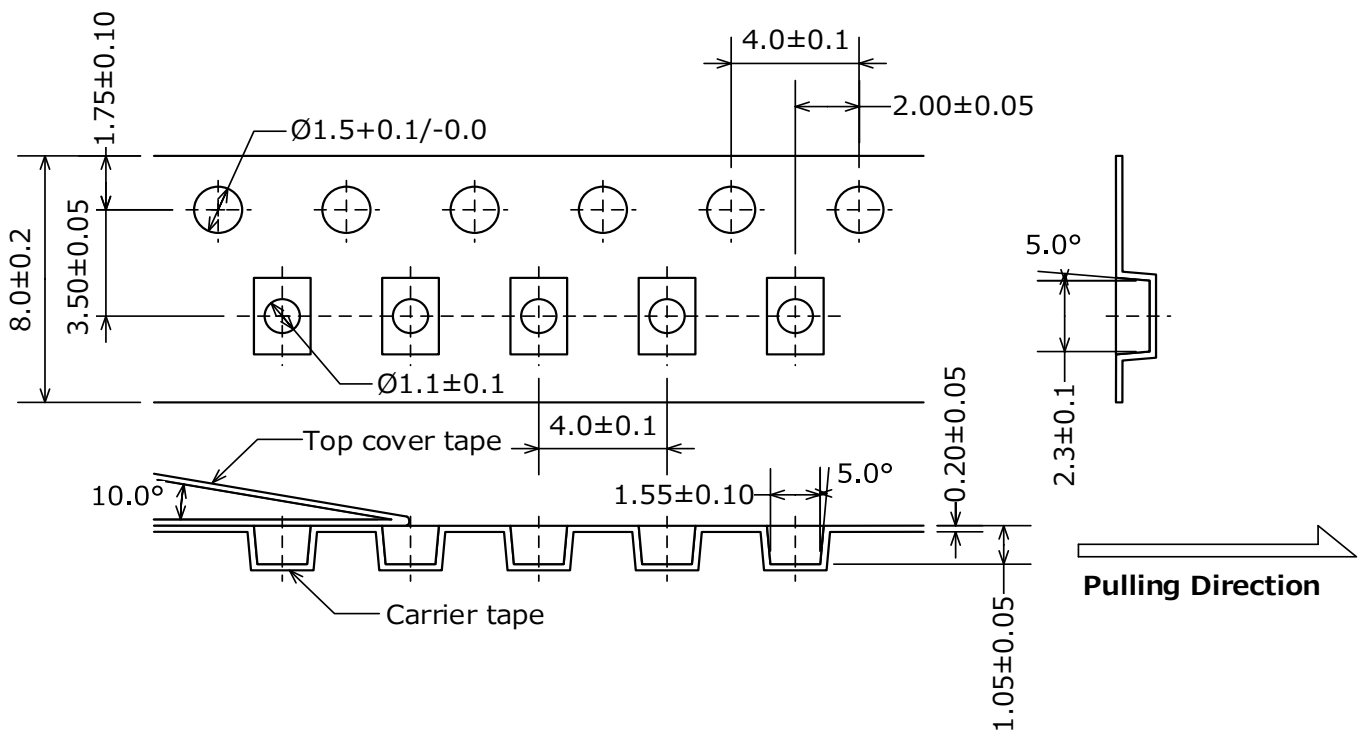

9.3 Carrier tape reel dimensions (Unit : mm)

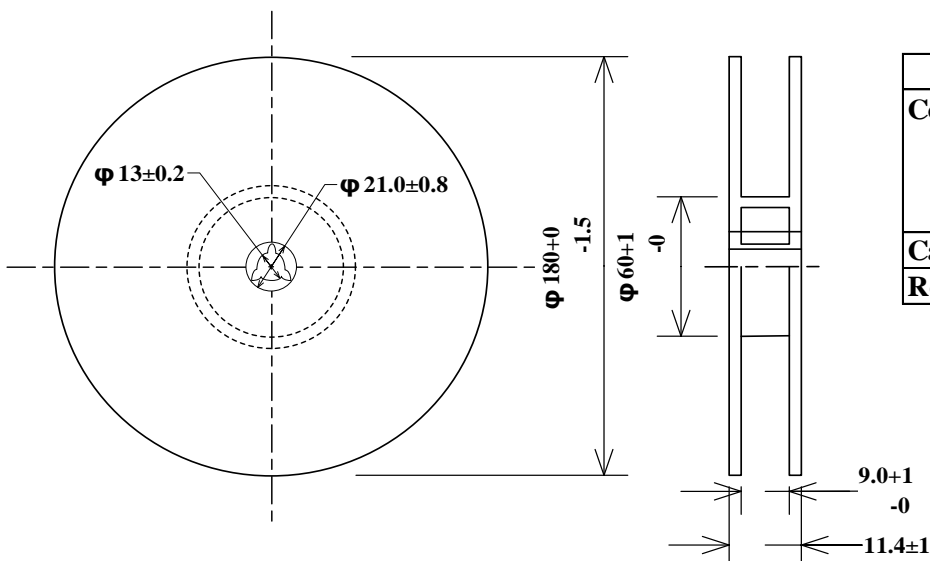

Material	
Cover tape	Polyester + LDPE + PS resin+ Conductive coat
Carrier tape	PS+Carbon
Reel	PS